

This drawing is to be read in conjunction with all other contract documents and specifications and all other consultants drawings.  
 All levels and dimensions should be checked on site and any discrepancies notified to the Architect prior to proceeding with works.  
 THIS DRAWING IS COPYRIGHT.  
 No drawing shall be reproduced in any form without prior written permission of Eric Parry Architects.

**NOTE:**  
 Existing site & building information based on survey information drawing 4230485/4101, dated November 2023, as provided by Glanvilles

- KEY**
- Planning application boundary
  - No development proposed
  - Existing buildings
  - Site access/ egress points

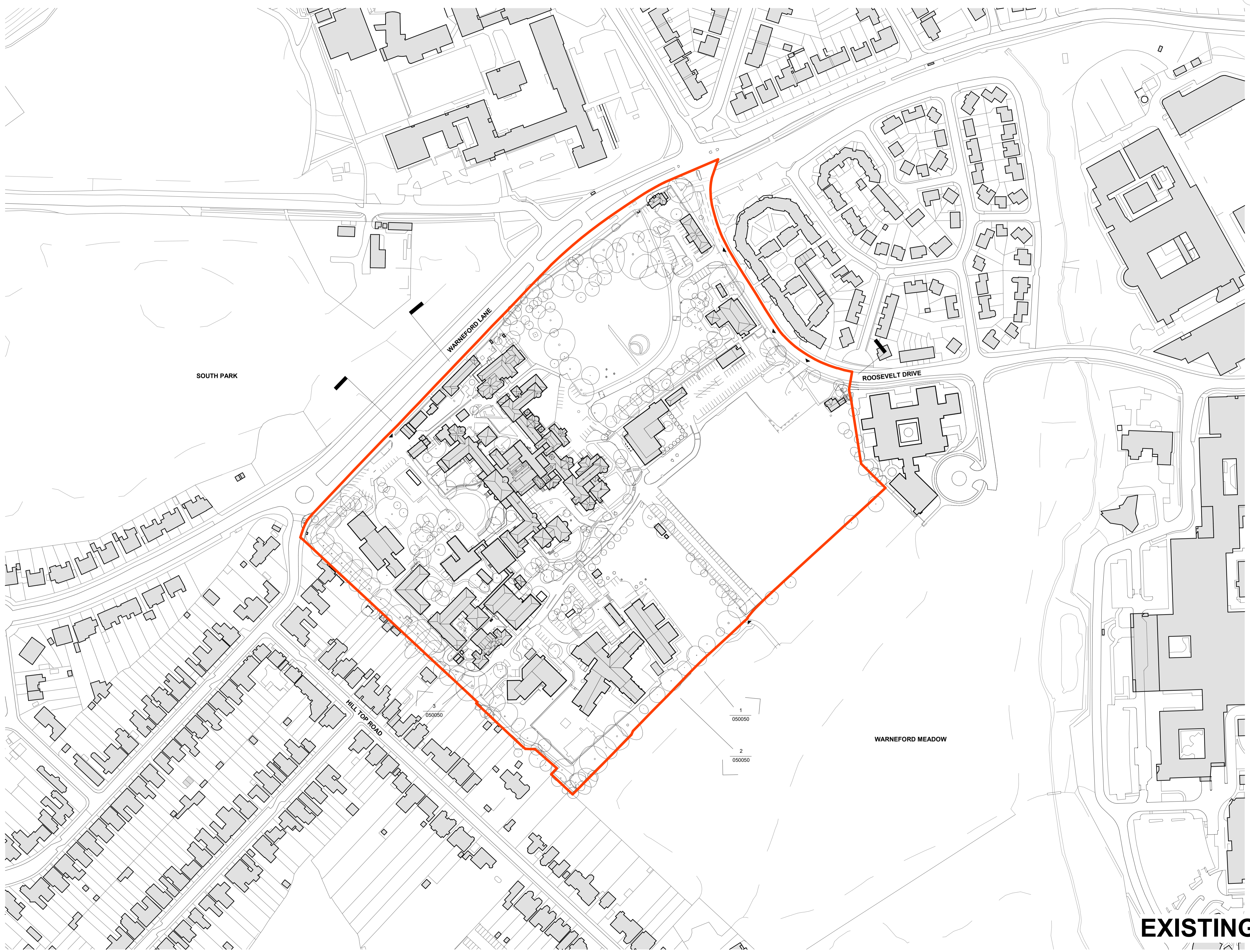

**For Planning Approval**

Rev	Description	Date	By	Chk
C00	For Planning	03/07/25	CH	JM

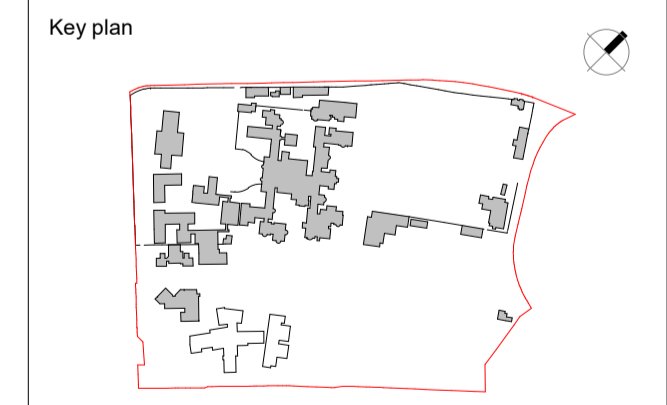

28 - 42 Banner Street  
 London EC1Y 8QE  
 Tel 020 7608 9600  
 Fax 020 7608 9601  
 www.ericparryarchitects.co.uk

**Eric Parry Architects**

client  
 Oxford Health NHS Foundation Trust

project  
 Warnford Park Masterplan

status description  
 For Planning

status code  
 A1

drawing title  
 Existing Masterplan Location Plan

scale  
 1:1250 @ A1

revision  
 C00

**EXISTING**

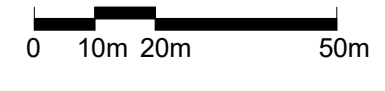

This page is intentionally left blank